

HAMPSTEAD INVENTORY HOMES



The Woodbury Floorplan

4 Bedroom, 3 Bath
2,261 sq. ft. conditioned approx.
Lot S-38

The Woodbury is one of the most exciting new home plans at Hampstead. It's gotten rave reviews since it was unveiling in 2018. This stunning 4 Bedroom Home is a 2-story house with one of the most popular architectural elevations at Hampstead! Enter into a popular open plan layout of dining and kitchen areas just left of the entry foyer. The gourmet kitchen features floor to ceiling custom cabinetry, gorgeous custom tile selections, stainless steel premium appliances, and great counter space. The living room with fireplace is filled with natural light. A flexible ground floor bedroom with bathroom could also be used as a study or formal dining room. Upstairs 3 bedrooms offer great children's rooms or guest rooms and a master suite with views that span the neighborhood.

1st Floor

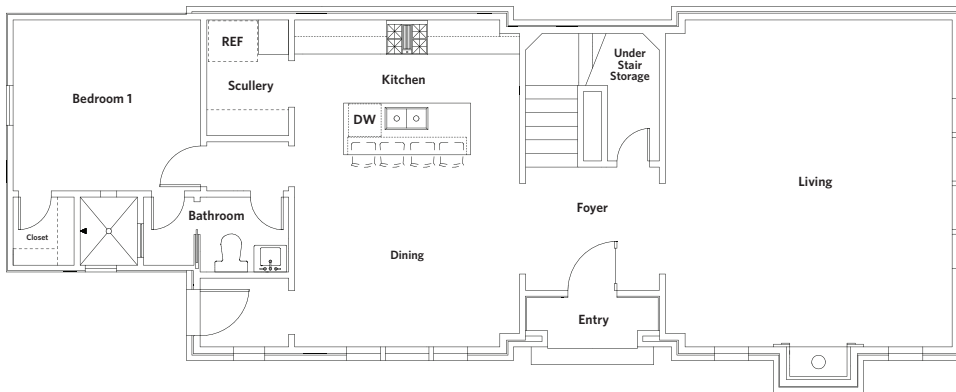

2nd Floor

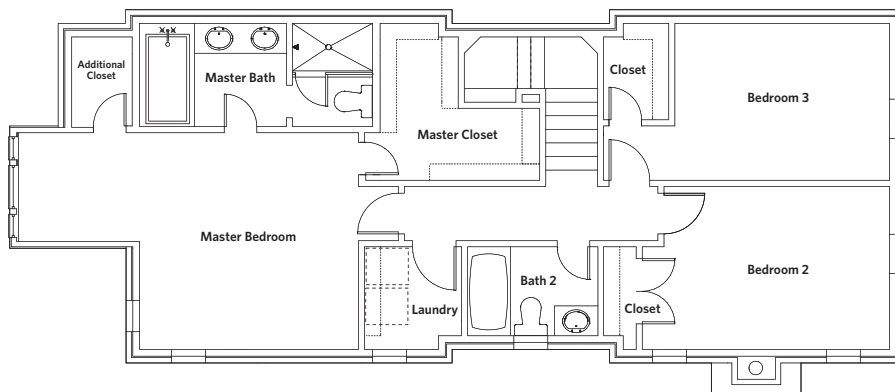

Features Include:

- Appliances: Stainless Steel Premium
- Building Materials: No-Rot Materials
- Cabinetry: Custom
- Countertops: Quartz
- Exterior: Painted Brick
- Flooring: Pre-Engineered Wood & Custom Tile
- Foundation: Post-Tension
- Garage: Detached, 2-car
- Insulation: Premium Insulation Package
- Lighting: Premium Light Fixtures
- Master: Upstairs
- Master Closets: Spacious and Additional Closets
- Windows: Pella Lo-E
- Window Treatments: Custom Drapery
- Yard: Spacious Private Courtyard

Builder: Mercer Home



For more information, visit our Hampstead Sales Home located at 7802 Portman Street.
334.270.6730 | sales@hampsteadcommunityrealty.com | www.hampsteadliving.com

