

Hampstead Inventory Homes



Photo Shows Previously Built Model

7979 Portman St.

The Woodbury

\$450,590

4 Bedroom, 3 Bath | 2 Car Detached Garage
2,261 sq. ft. conditioned approx.
2775 sq. ft. total under roof
Lot S-36

This stunning 4 bedroom, 2-story home has one of the most popular architectural elevations at Hampstead! Enter into a popular open plan layout of dining and kitchen areas just left of the entry foyer. The gourmet kitchen features floor to ceiling custom cabinetry, gorgeous custom tile selections, stainless steel premium appliances, and great counter space. The living room with fireplace is filled with natural light. A flexible ground floor bedroom with bathroom could also be used as a study or formal dining room. Upstairs 3 bedrooms offer great children's rooms or guest rooms and a master suite with views that span the neighborhood.

1st Floor

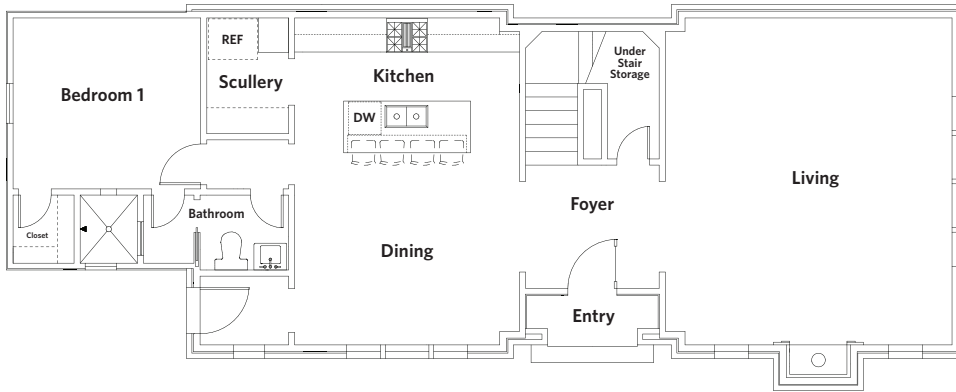

2nd Floor

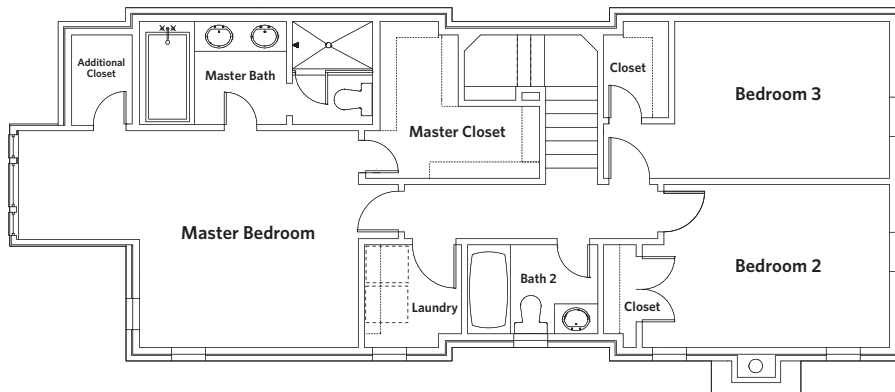

Features Include:

- Appliances: Energy Star
- Building Materials: No-Rot Materials
- Cabinets: Custom with Soft Close Hinges
- Countertops: Quartz
- Entry: Covered Entry with Front Porch
- Exterior: Painted Brick, Hardi Siding
- Flooring: Pre-Engineered Wood, Carpet, Ceramic Tile
- Foundation: Post-Tension
- Garage: Detached, 2-car
- Insulation: Premium Insulation Package
- Lighting: Premium Light Fixtures
- Master: Upstairs with Additional Storage Closet
- Master Closets: Spacious Walk-In Closet
- Windows: Pella Low-E
- Yard: Spacious Private Courtyard



For more information, visit our Hampstead Sales Home located at 7802 Portman Street.
 334.270.6730 | sales@hampsteadcommunityrealty.com | www.hampsteadliving.com

