

COMPLEXE IBERIA — BUILDING A

25 avenue Inverness,
Candiac, QC J5R 3L6



François Boyer, CPA

V-p. Développement

+1 (438) 600-2804

fboyer@plan-a.ca

COMPLEXE IBERIA — ENLARGED PLAN

25 avenue Inverness,
Candiac, QC J5R 3L6

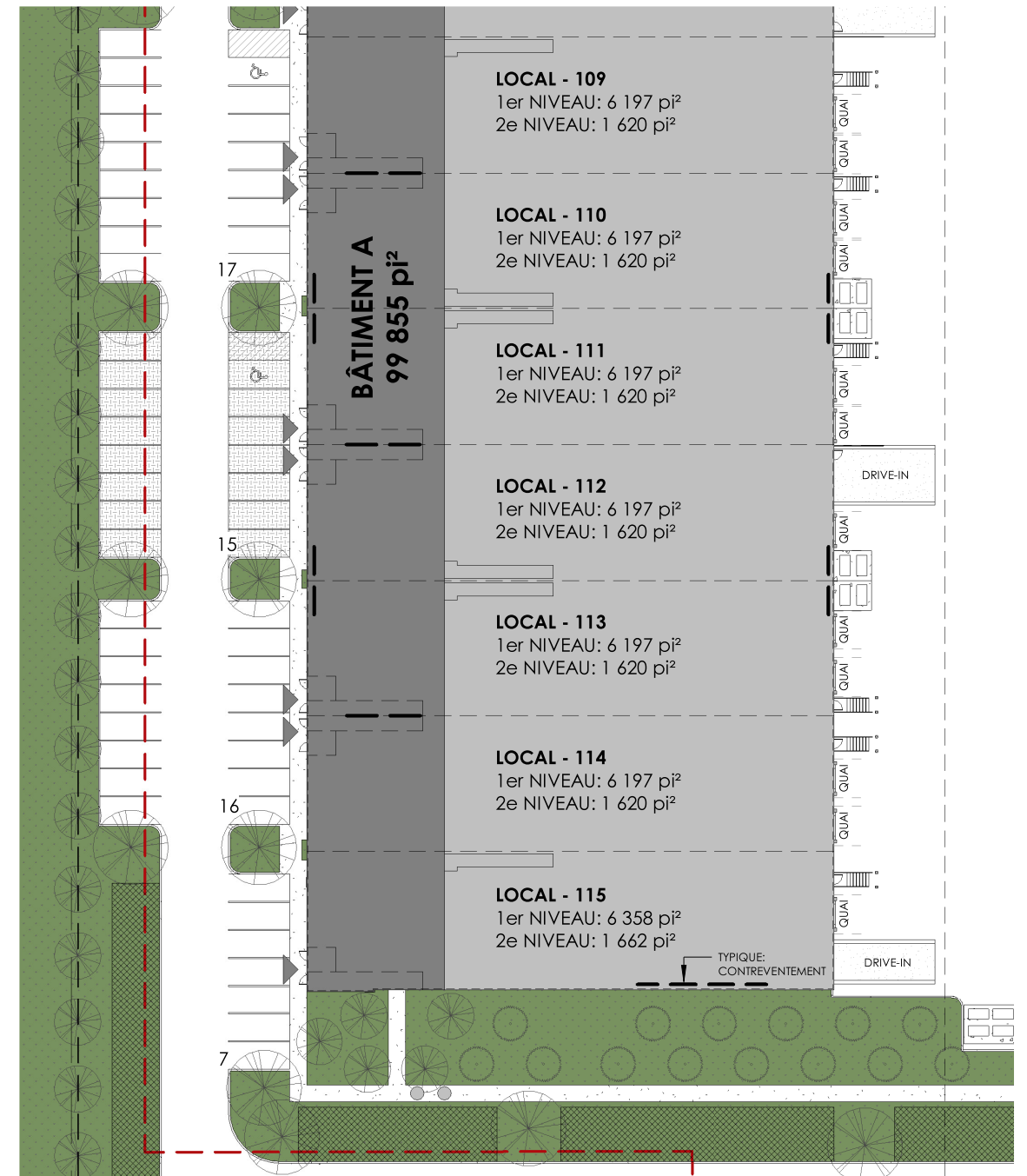
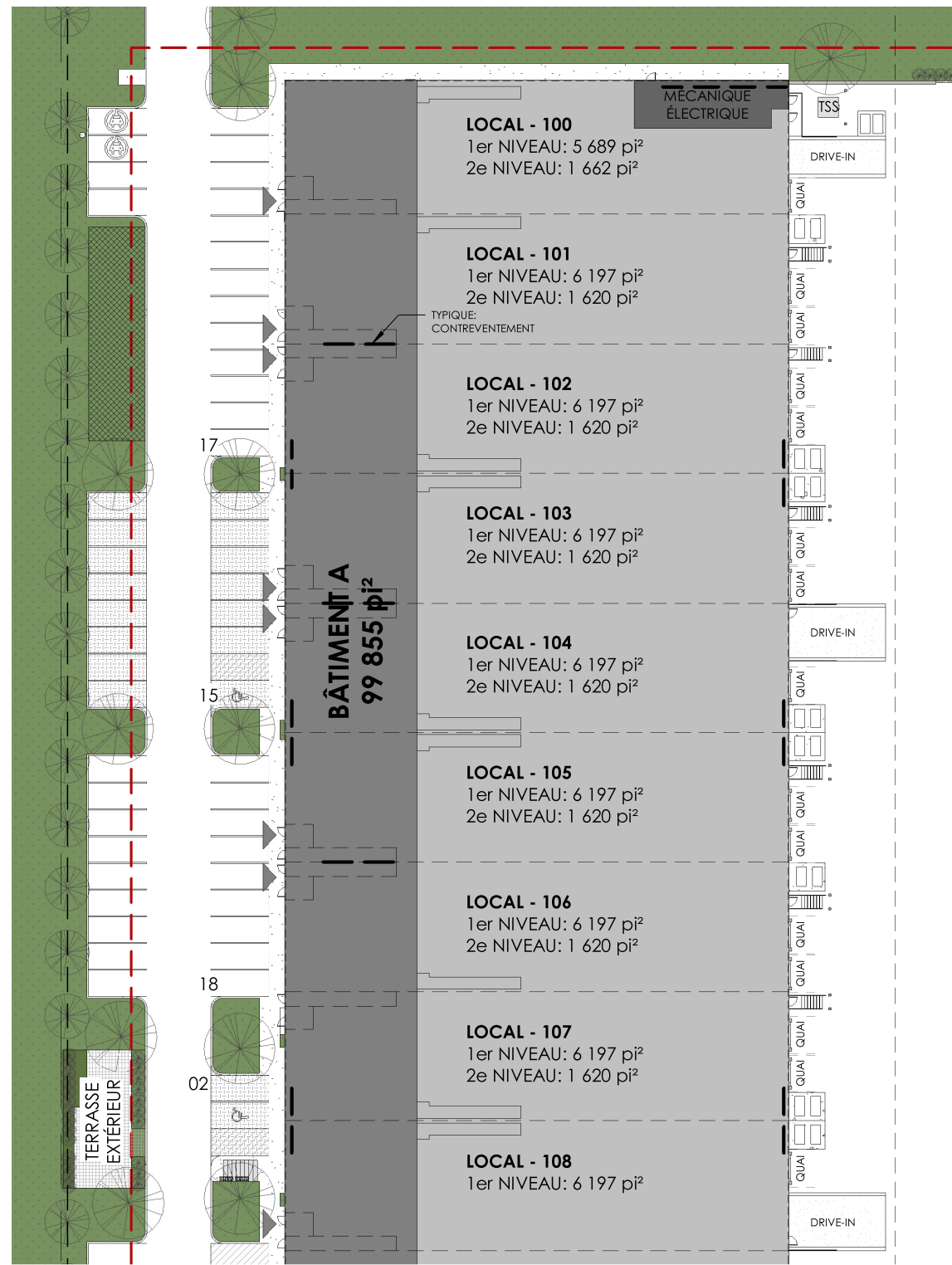

François Boyer, CPA

V-p. Développement

+1 (438) 600-2804

fboyer@plan-a.ca

**COMPLEXE IBERIA
— LOCAL STYLE**

**25 avenue Inverness,
Candiac, QC J5R 3L6**

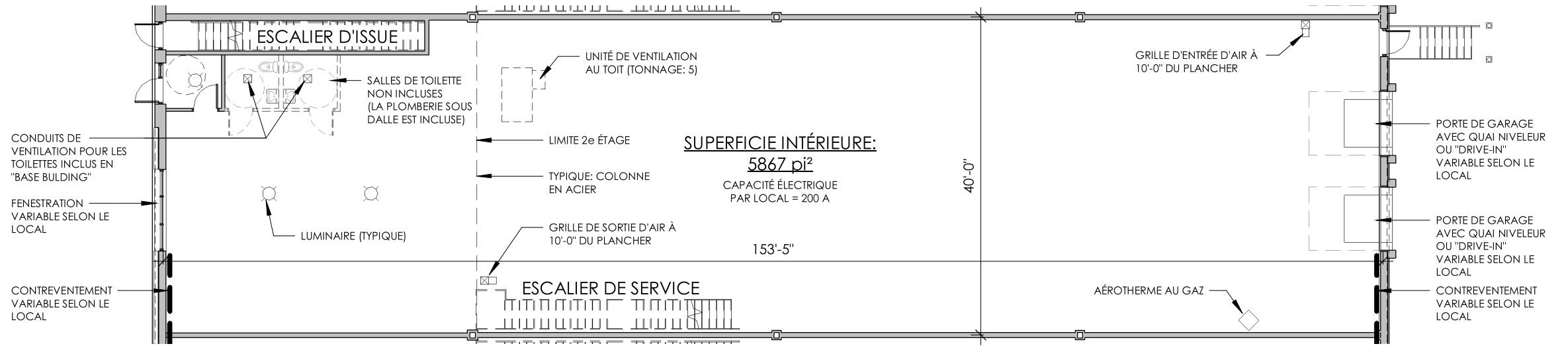

LOCAL TYPE - 1er ÉTAGE

1/16" = 1'-0"

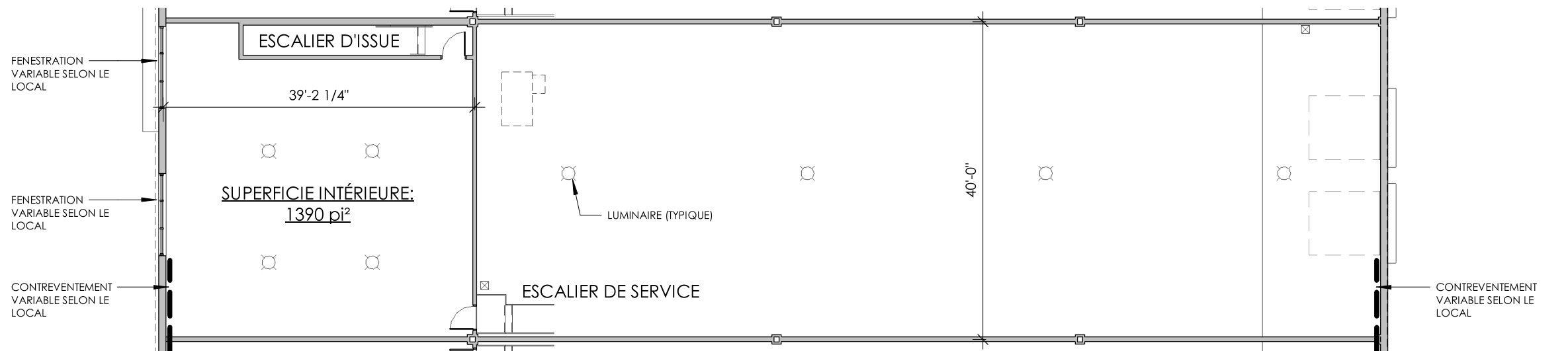

LOCAL TYPE - 2e ÉTAGE

1/16" = 1'-0"

François Boyer, CPA

V-p. Développement

+1 (438) 600-2804

fboyer@plan-a.ca